

Project:
Weesper sluis 3B;

Fase:
Verkooptekeningen

Schaal:

formaat:
A3

Datum:
19-01-2024

project nummer:
0583

tekening nummer:
VK-129-0100

tekening naam:
Voorblad

Type:
Blok 30





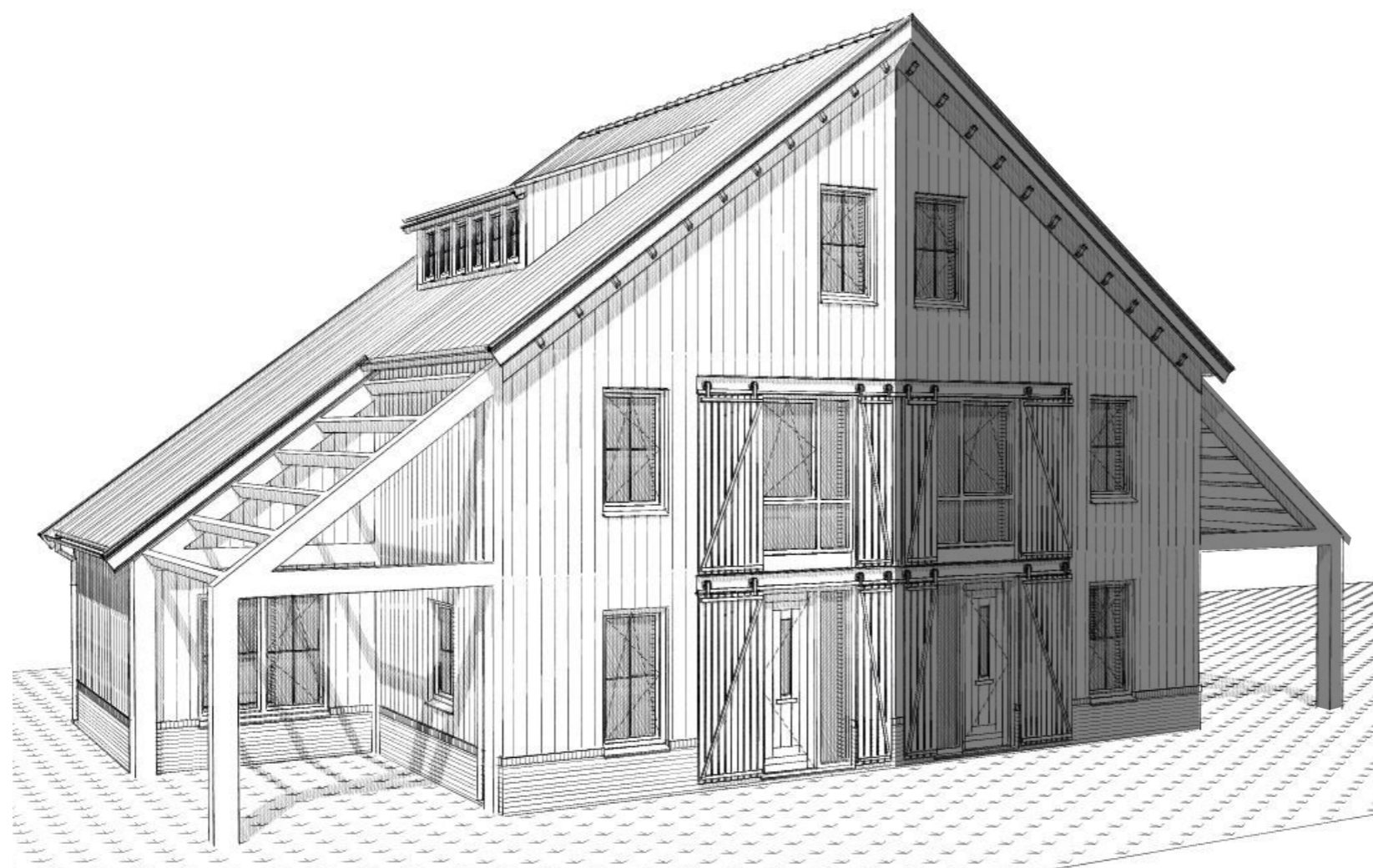
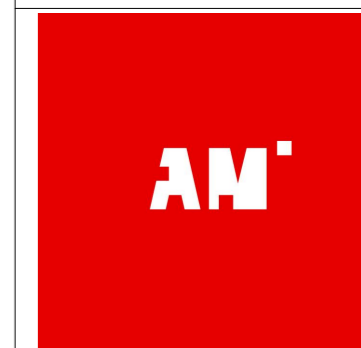

Getekend:
LB

Weesperhoeve





















Tweekapper
Type 2K-04 (9,6m)
Bouwnummer
129



installaties

- electra conform het bouwbesluit
-  deurbel
-  wandlichtpunt
-  plafondlichtpunt
-  enkelpolige schakelaar
-  wisselschakelaar
-  serieschakelaar
-  wandcontactdoos dubbel geaard, horizontaal
-  wandcontactdoos enkel geaard
-  rookmelder (aangesloten op lichtnet) conform NEN2555
-  aansluiting wasmachine
-  aansluiting pv-panelen
-  aansluiting mechanische ventilatie
-  aansluiting radiator
-  aansluiting verdeler vloerverwarming kamerthermostaat
-  CO2 gestuurde ventilatie
-  aansluiting wasdroger
-  buitenkraan
-  aansluiting centrale antenne inrichting
-  aansluiting netwerkkabel
-  binnenvoeler verwarmingssysteem

bouwkundig

-  meterkast
-  mechanische ventilatiebox
-  PV panelen
-  batterij t.b.v. energieopslag pv-panelen
-  PV omvormer
-  warmtepomp
-  opstelplaats droger/wasmachine
-  kruipluik
-  boiler
-  CV-verdeler
-  CV-verdeler met omkasting
-  elektrische radiator
-  woningscheidende wand
-  binnenwand 100mm
-  gevelpakket
-  gevelsteen-spouw-isolatie-binnenblad
-  tegelwerk
-  Loopdeur
-  HWA
-  ventilatiekooster boven kozijn (in het glas t.p.v. pui achtergevel)
-  vloerverwarming

voor mechanische ventilatie zijn in verblijfsruimtes toevoerpunten en in badruimte, toilet, keuken en technische ruimte afvoerpunten aanwezig. Positie en aantal nader te bepalen.

installaties en schachten qua positie en afmetingen indicatief.

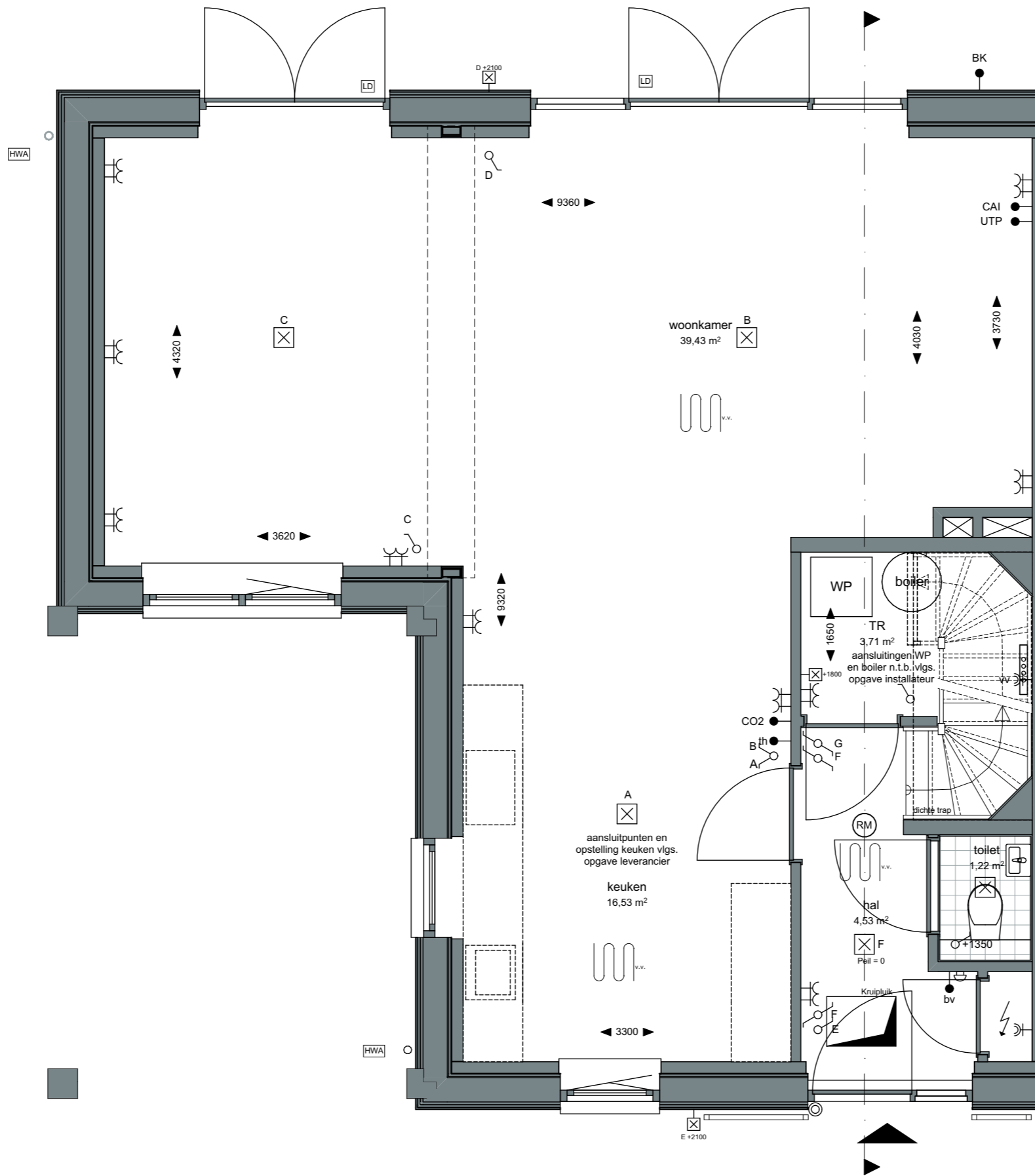

Project:
 Weesperluis 3B;

Fase:
 Verkooptekeningen

Schaal:
 1:50

formaat:
 A3

Datum:
 19-01-2024

project nummer:
 0583

tekening nummer:
 VK-129-0101

tekening naam:
Begane grond

Type:
Blok 30

Getekend:
 LB

Weesperhoeve

Tweekapper
 Type 2K-04 (9,6m)
 Bouwnummer
 129



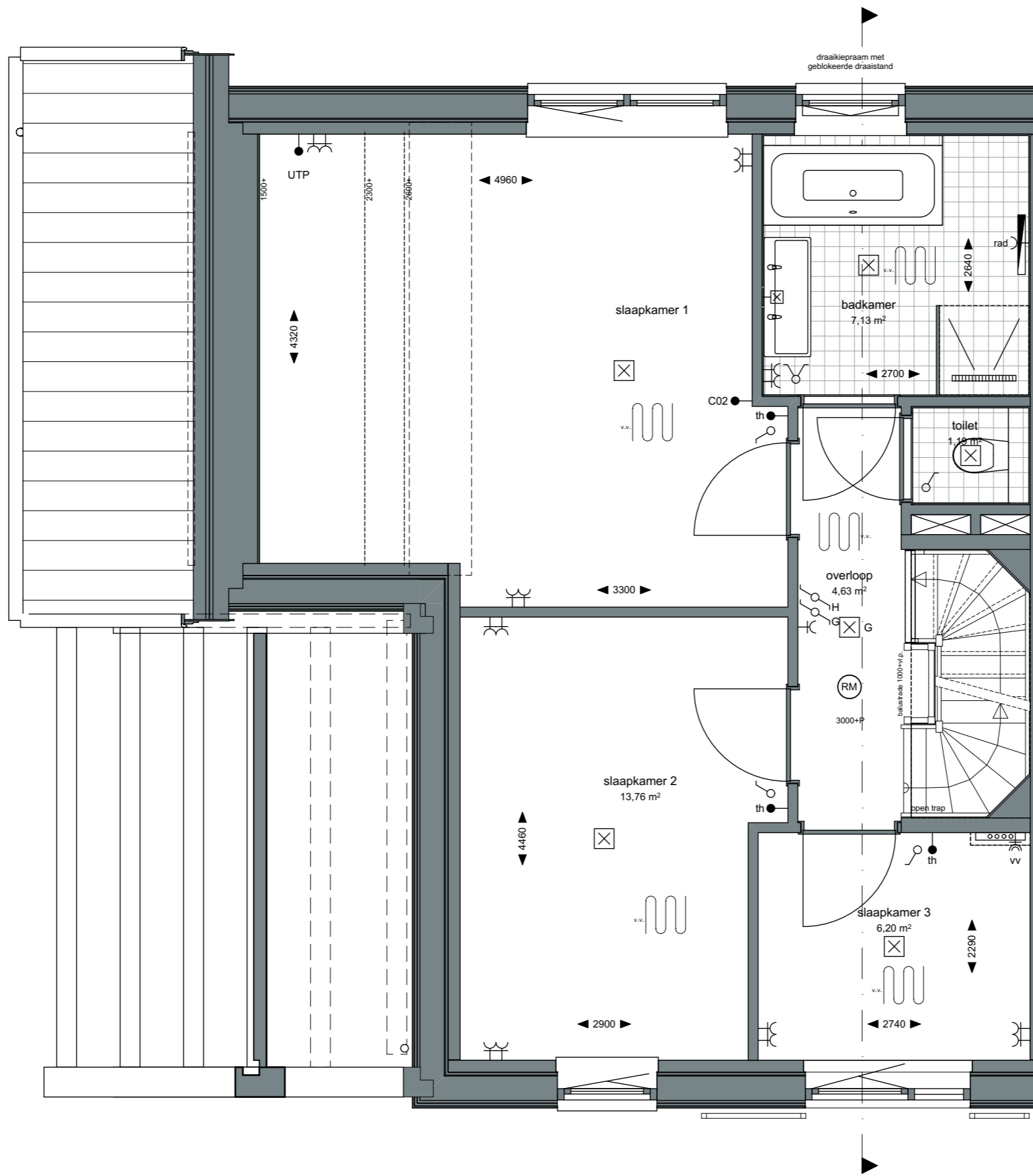

Project:
Weesperhoeve 3B;

Fase:
Verkooptekeningen

Schaal:
1:50

formaat:
A3

Datum:
19-01-2024

project nummer:
0583

tekening nummer:
VK-129-0102

tekening naam:
Eerste verdieping

Type:
Blok 30

Getekend:
LB

Weesperhoeve

 Tweekapper
 Type 2K-04 (9,6m)
 Bouwnummer
 129



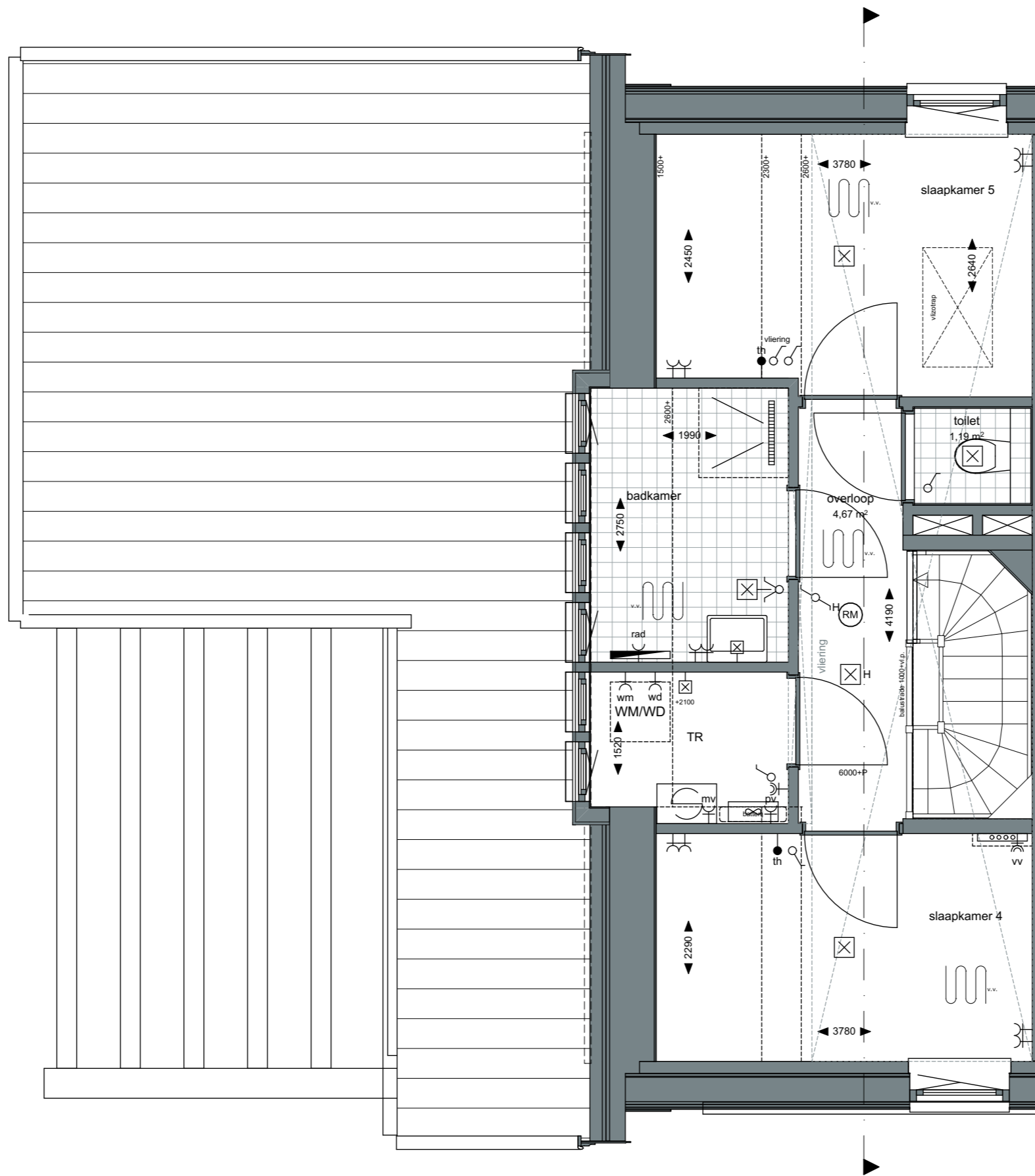

Project:
 Weesperluis 3B;

Fase:
 Verkooptekeningen

Schaal:
 1:50

formaat:
 A3

Datum:
 19-01-2024

project nummer:
 0583

tekening nummer:
 VK-129-0103

tekening naam:
Tweede verdieping

Type:
Blok 30

Getekend:
 LB

Weesperhoeve
 Tweekapper
 Type 2K-04 (9,6m)
 Bouwnummer
 129



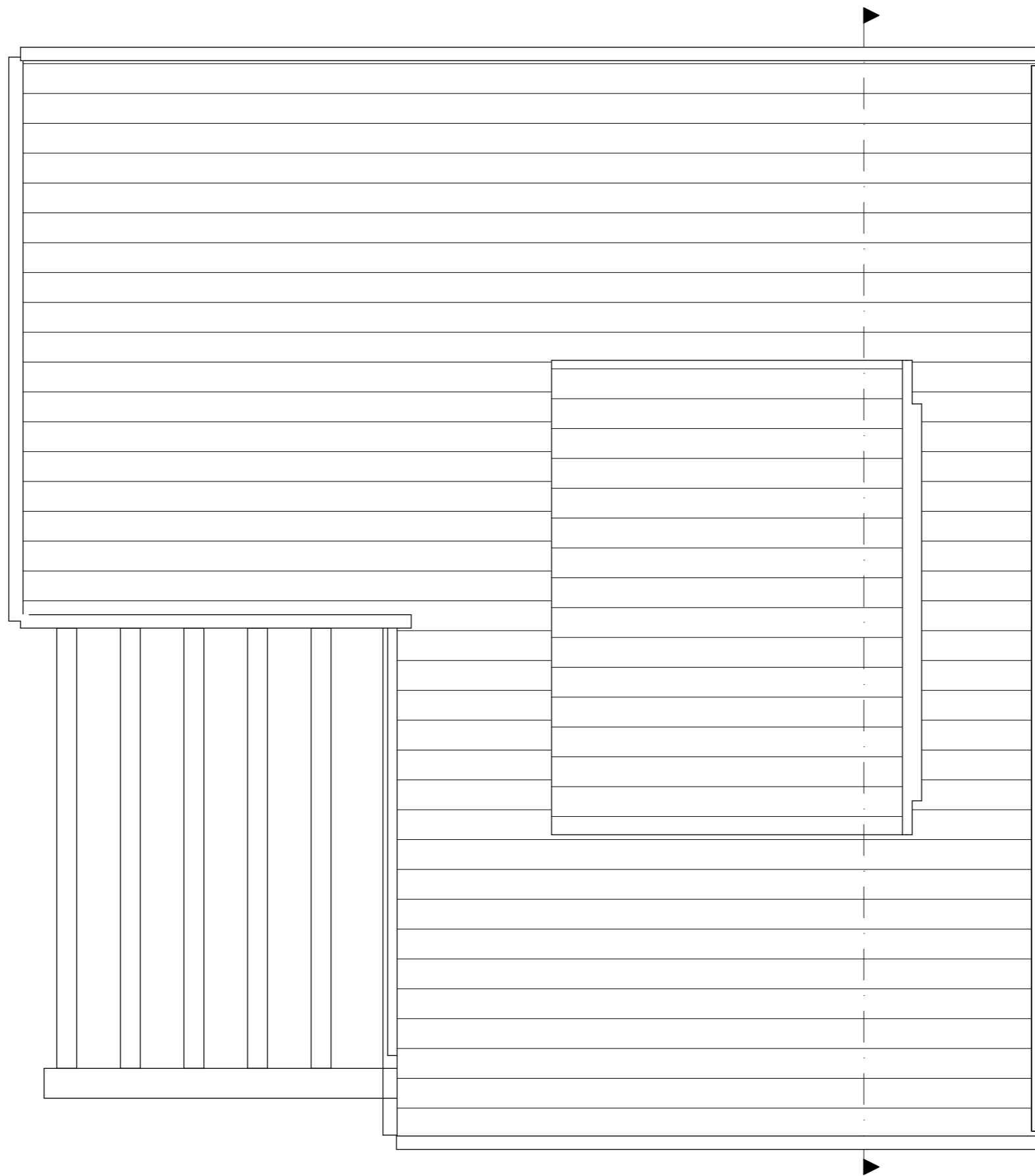

ZVA

Zeinstra Veerbeek Architecten

info@zeinstraveerbeek.nl



**WEESPER
SLUIS**

Project:
Weesperluis 3B;

Fase:
Verkooptekeningen

Schaal:
1:50

formaat:
A3

Datum:
19-01-2024

project nummer:
0583

tekening nummer:
VK-129-0104

tekening naam:
Dak

Type:
Blok 30

Getekend:
LB

Weesperhoeve

Tweekapper
Type 2K-04 (9,6m)
Bouwnummer
129

AM'

ZVA

Zeinstra Veerbeek Architecten

info@zeinstraveerbeek.nl



**WEESPER
SLUIS**

Project:
Weesperluis 3B;

Fase:
Verkooptekeningen

Schaal:
1:100

formaat:
A3

Datum:
19-01-2024

project nummer:
0583

tekening nummer:
VK-129-0105

tekening naam:
Gevels/Doorsnede

Type:
Blok 30

Getekend:
LB

Weesperhoeve

Tweekapper
Type 2K-04 (9,6m)
Bouwnummer
129

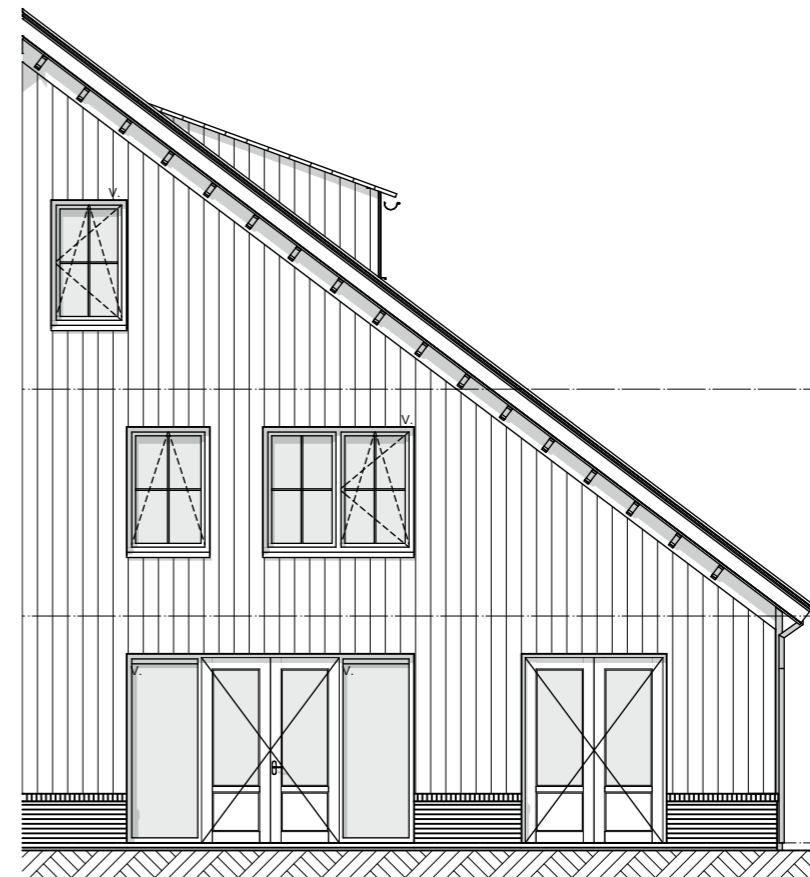
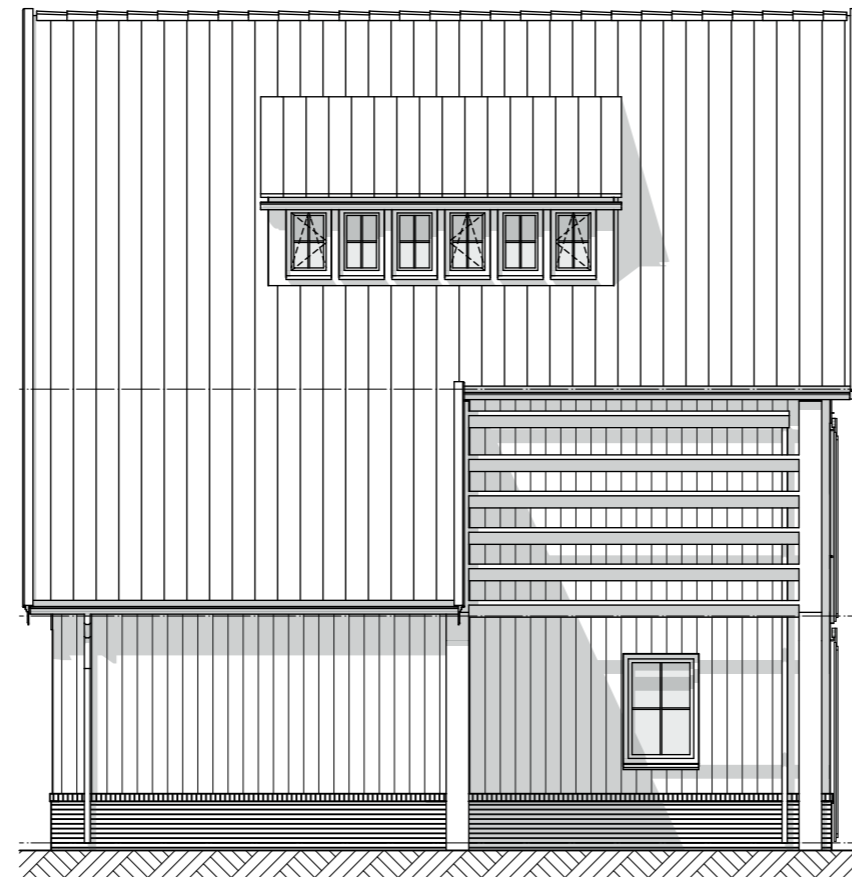
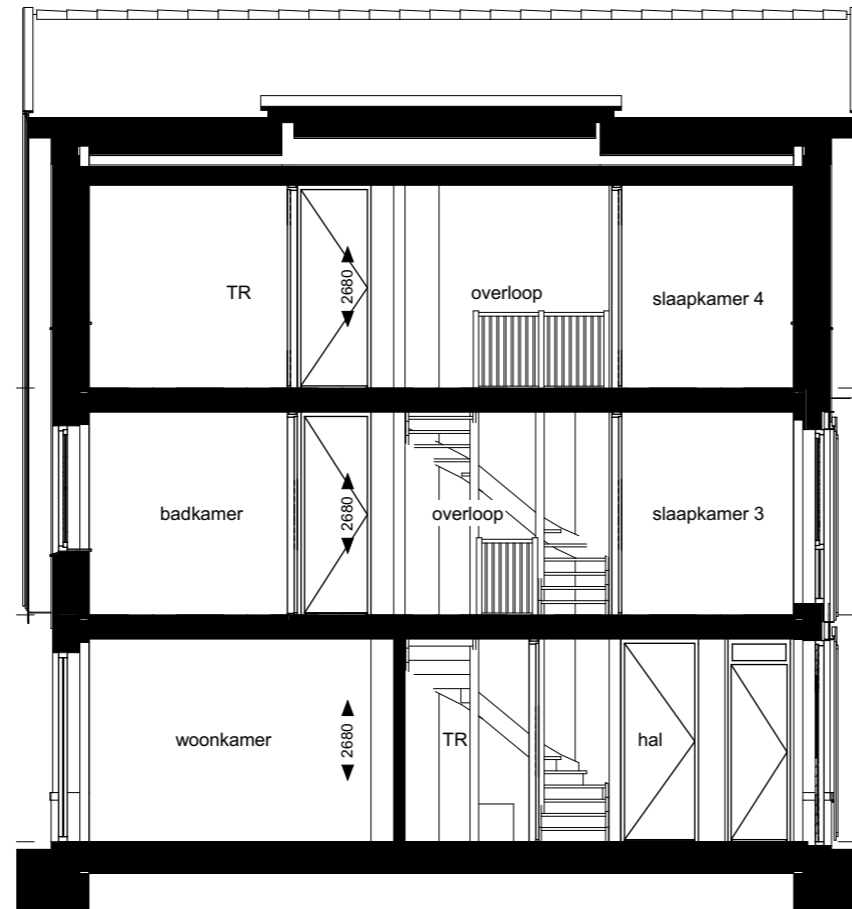

AM